



C.C.JENSEN A/S
Windows

Clamp-On Windows



Easy mounting - no welding

WINDOW TECHNOLOGY
MARINE SOLUTIONS

A new generation in window technology

“Safety - energy saving and good looking design”



C.C. Jensen Windows has developed a new generation of ship windows after interviewing several shipyards and out-fitting companies how we could make their every day life more simple.

Logistics advantage

Usually windows are welded in during the building of the hull.

Because of the welding the glass have to be protected by a wooden plate to avoid damage from sand-blasting and painting.

By using clamp-on windows the mounting process takes place at a later stage in the building process. Therefore the shipyard can use the opening in the bulkhead which gives more flexibility during the building period.

Installation time

The estimated installation time for the clamp-on window will be max. 30 minutes, compared to up to 4 hours for a window for welding in.

Reducing wasted time

Do you realize the time spent – a lot of annoying time – when you have to repair damaged or deteriorated windows?

It is possible to reduce the installation time by app. 85% by using the new clamp-on window.

Technical info

The frames and clamps are manufactured from high quality **extruded aluminium** profile.

The clamps are fitted with self-locking **stainless steel** screws secured with locking adhesive. The glass is glued into the frame by a special adhesive developed for maritime use.

Water tightness in the superstructure is obtained by a **gasket specially developed** by C.C. Jensen. Tightness will be enforced by increased pressure from the outside.

The **step** glass is a factor for obtaining a stronger window.

Safe construction: According to the pressure described in ISO 3903 the clamp-on window withstands 4 times higher water pressure.

Conservation: The surface is pre-treated (anodized) and covered with a powder coating of 50-120µ.

Noise reduction

Three vital parameters are determining the noise reduction:

- Ship layout
- Application of low noise sources
- Design of low noise windows

One major advantage of the clamp-on window is the high noise reduction. When correctly installed, they'll provide maximum quiet and comfort through absorption of unwanted structural and air-borne noise due to no direct steel connection.

Weight

Do you wish to save weight then you should consider the clamp-on window.



Mounting

The clamp-on window frame is placed in the cut-out hole and kept into position with clamps.

Two different frame types are available. One for mounting in bulkhead of max. 20 mm and one for mounting in bulkhead of max. 25 mm.

The distance between the frame and bulkhead is minimum 2 mm all the way round to adapt the movements of the hull. For fire rated windows an insulation box is supplied to obtain the fire resisting requirements.

It will be fitted with a “click-on” feature.

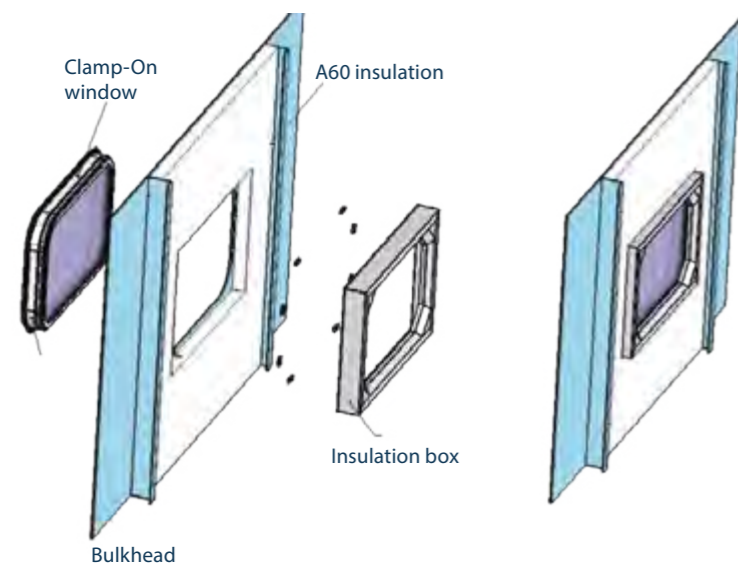

Noise reduction

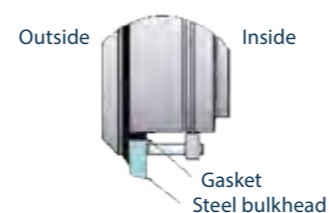

Mounting the Clamp-On Window

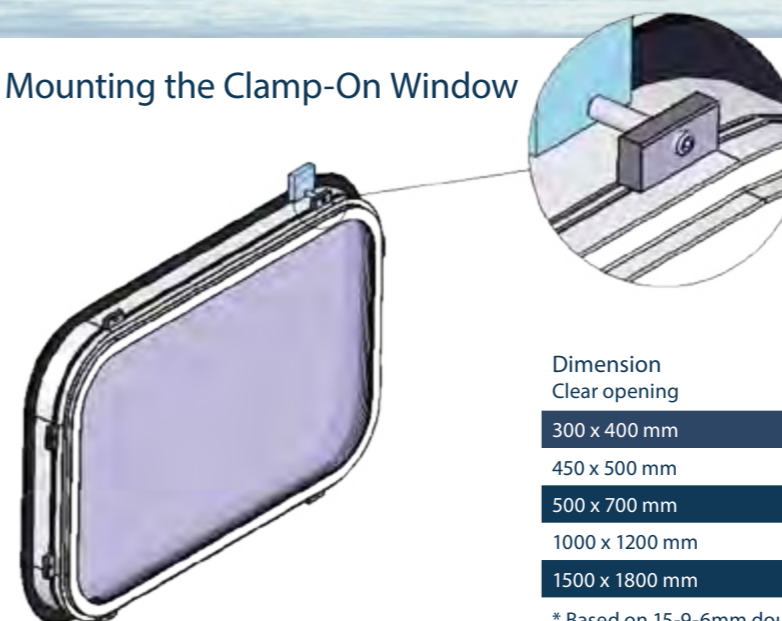

Dimension Clear opening	Clamp-on Window 80 mm aluminium profile	Fixed welded window 100 mm steel profile
300 x 400 mm	12,7 kg	17,6 kg
450 x 500 mm	20,7 kg	26,9 kg
500 x 700 mm	29,2 kg	37,3 kg
1000 x 1200 mm	82,6 kg	97,0 kg
1500 x 1800 mm	171,8 kg	192,4 kg

* Based on 15-9-6mm double glass.



- With C.C.Jensen **next generation** of window solutions you can expect **more**

A0 / A60 windows resisting fire from the inside

The new clamp-on window is tested to fulfil A0 and A-60 requirements against fire from the inside. The glass is build up by a double glass solution.

The clamp-on window complies with the IMO regulations SOLAS 1974 including later amendments and is approved by all major classification societies and authorities.

Certificates are available on request.

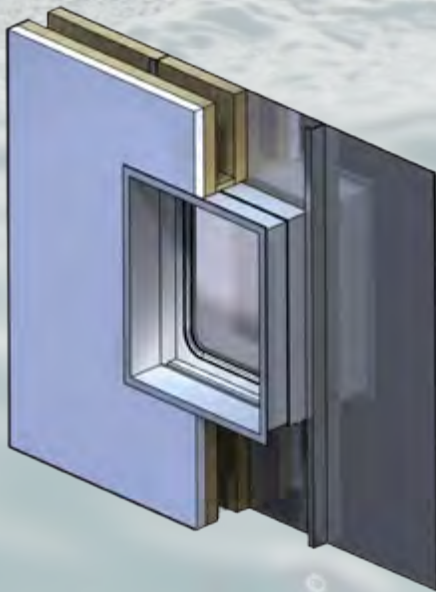

You are welcome to **contact us**, if you **have questions about**

- Representatives
- Design
- Engineering
- Documentation
- Manufacturing
- Repair & maintenance



C.C.JENSEN A/S
Windows

Løvholmen 13
DK-5700 Svendborg
Denmark

Tel +45 63 21 20 14
windows@cjcdk
www.cjc-windows.dk